

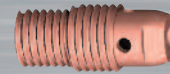

Insulator  
Pack Size = 10



Collet  
Pack Size = 10



Collet Body  
Pack Size = 10



Ceramic  
Pack Size = 10

Electrode Ø	Nozzle Size
0.5 mm	No. 4
1.0 mm	No. 5
1.6 mm	No. 6
2.4 mm	No. 7
3.2 mm	No. 8

Part No.
BIN598882

Part No.
BIN13N20
BIN13N21
BIN13N22
BIN13N23
BIN13N24

Part No.
-
BIN13N26
BIN13N27
BIN13N28
BIN13N29

Part No.
BIN13N08
BIN13N09
BIN13N10
BIN13N11
BIN13N12

### Why use a Gas Lens setup?

A **Gas Lens** setup is required for use in high quality integrity welding applications where a superior/precise gas coverage is necessary & an extended tungsten stick-out is required.

### Small Gas Lens Setup



Insulator  
Pack Size = 10



Collet  
Pack Size = 10

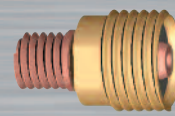

Gas Lens  
Pack Size = 5



Ceramic  
Pack Size = 10

Electrode Ø	Nozzle Size
0.5 mm	No. 4
1.0 mm	No. 5
1.6 mm	No. 6
2.4 mm	No. 7
3.2 mm	No. 8

Part No.
BIN598882

Part No.
BIN13N20
BIN13N21
BIN13N22
BIN13N23
BIN13N24

Part No.
-
BIN45V42
BIN45V43
BIN45V44
BIN45V45

Part No.
BIN53N58
BIN53N59
BIN53N60
BIN53N61
-

### Why use a Gas Lens setup?

A **Gas Lens** setup is required for use in high quality integrity welding applications where a superior/precise gas coverage is necessary & an extended tungsten stick-out is required.

### Large Gas Lens Setup



Insulator  
Pack Size = 10



Collet  
Pack Size = 10

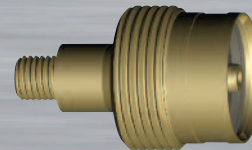

Gas Lens  
Pack Size = 2



Ceramic  
Pack Size = 10

Electrode Ø	Nozzle Size
0.5 mm	No. 4
1.0 mm	No. 5
1.6 mm	No. 6
2.4 mm	No. 7
3.2 mm	No. 8
-	No. 10
-	No. 12

Part No.
BIN54N63-20

Part No.
-
BIN13N21L
BIN13N22L
BIN13N23L
BIN13N24L
-
-

Part No.
-
-
BIN45V116S
BIN45V64S
-
-
-

Part No.
-
-
BIN57N75
-
BIN57N74
BIN53N88
BIN53N87